



**FORCE®**  
high performance SBS waterproofing

# FORCE®

**LINE | SOLO | ALPAL | TRAFIC**  
High performance SBS waterproofing  
*trusted by professionals*



**PROFESSIONAL** roofing contractors demand professional materials from specialist manufacturers. Axter is one of the world's leading manufacturers of roofing products and systems with over 100 years experience of industrial waterproofing production. Axter specialises in the fabrication of high quality, cost effective bituminous membranes that offer unparalleled performance and durability worldwide.



# BENEFITS

like high strength and durability make the FORCE® system range a popular choice for professional roofers. Advantages of Axter torch on roofing systems are;

- Life expectancy in excess of 50 years (60 years with ALPA® binder products)
- Robust with excellent point load resistance and self healing properties
- High elasticity to accommodate structural movement
- SBS (Styrene Butadiene Styrene) provides superior bond strength
- Unique ALPA® binder provides advanced single layer performance
- Quick and simple installation and detailing
- Design flexibility with a wide range of aesthetic choices
- CE marked and British Standard (BS 8747:2007) compliant
- Minimum AC and AA fire rated products available
- Enhanced ageing, weathering and UV resistance
- Self adhesive and cold applied liquid options available



# FIRE PERFORMANCE

is an essential consideration when designing and constructing all buildings. The fire resistance of the flat roof covering, in terms of penetration and spread of flame from the outside of the building, is crucial.

Axter systems conform to and exceed the requirements of The Building Regulations 2010, Approved Document B Fire Safety. BS 8747:2007 Reinforced bitumen membranes for roofing - Guide to selection and specification Clause 4.6.10 External Fire Performance states "The current toughest regulatory requirement under the UK Building Regulations (fire performance) is for an AC rating, when tested to BS 476-3:2004".

FORCE® systems self protected with mineral granules will achieve a minimum AC fire performance rating. FORCE® SOLO and FORCE® ALPAL single layer overlay membranes achieve AA designation.



# ELIMINATING RISK

and

increasing fire safety during and post waterproofing installation forms part of Axter's unique approach. **FORCE SA** self adhesive membranes and **STARCOAT R** cold applied bitumen liquid detailing eliminate the need for torch-on naked flame installation. This is ideal for combustible substrates and in high risk detail and perimeter zones on new build or refurbishment projects.



# CLIENT WARRANTIES

are delivered on all FORCE® system projects when materials are purchased via a recognised partner stockist. These warranties are long term and provide complete reassurance to the client.

FORCE® systems have been developed to safeguard client and contractor confidence and ensure the delivery of high quality, durable and cost-effective roofing solutions that meet the demands of all projects. Long term Axter warranties covering materials and labour are available when using FORCE® systems up to a market leading period of 25 years.



# TORCH ON

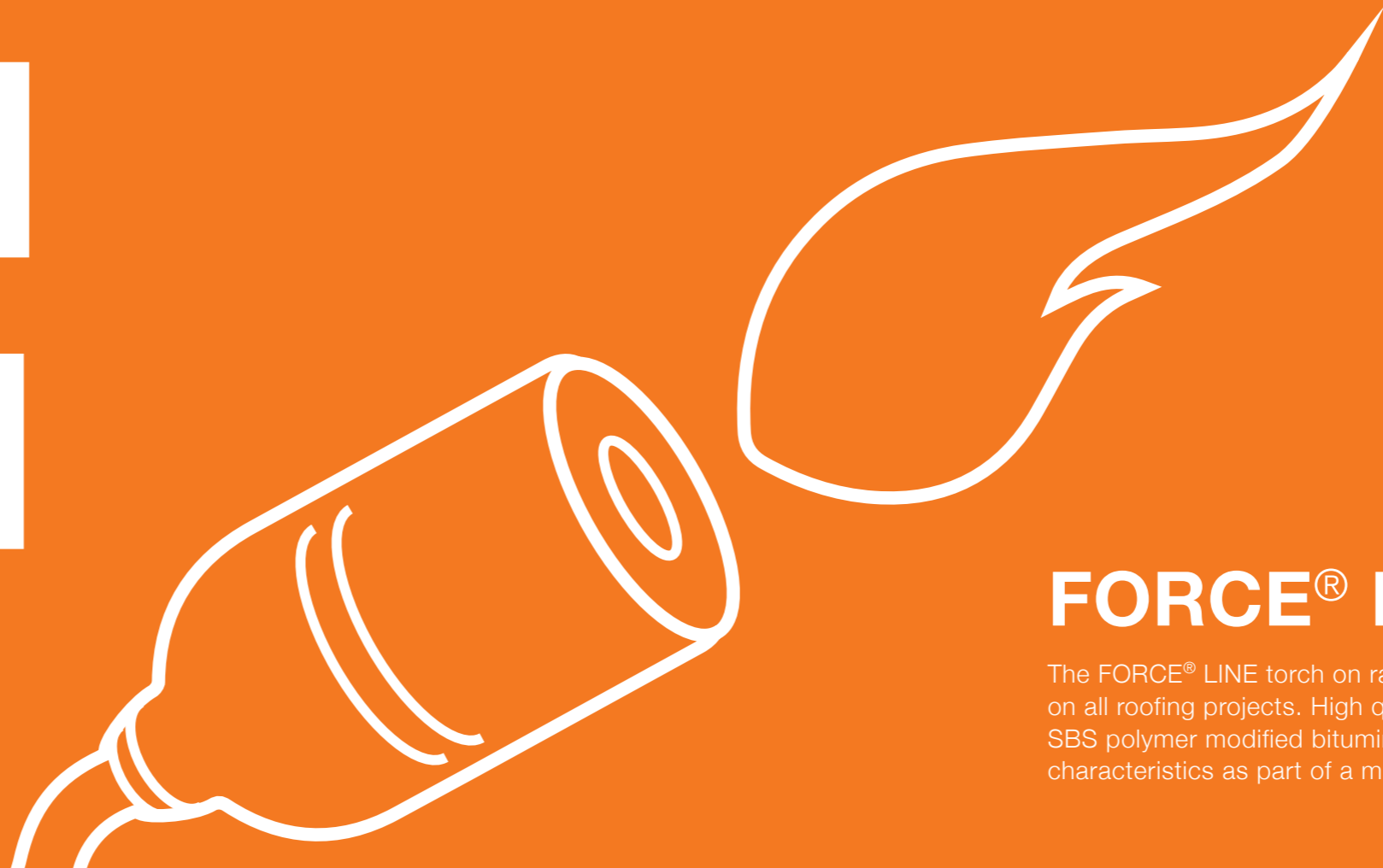

## **FORCE<sup>®</sup> LINE**

The FORCE<sup>®</sup> LINE torch on range has been specially manufactured for use on all roofing projects. High quality, proven and robust, the FORCE<sup>®</sup> LINE SBS polymer modified bituminous membranes offer excellent performance characteristics as part of a multi-layer system build up.

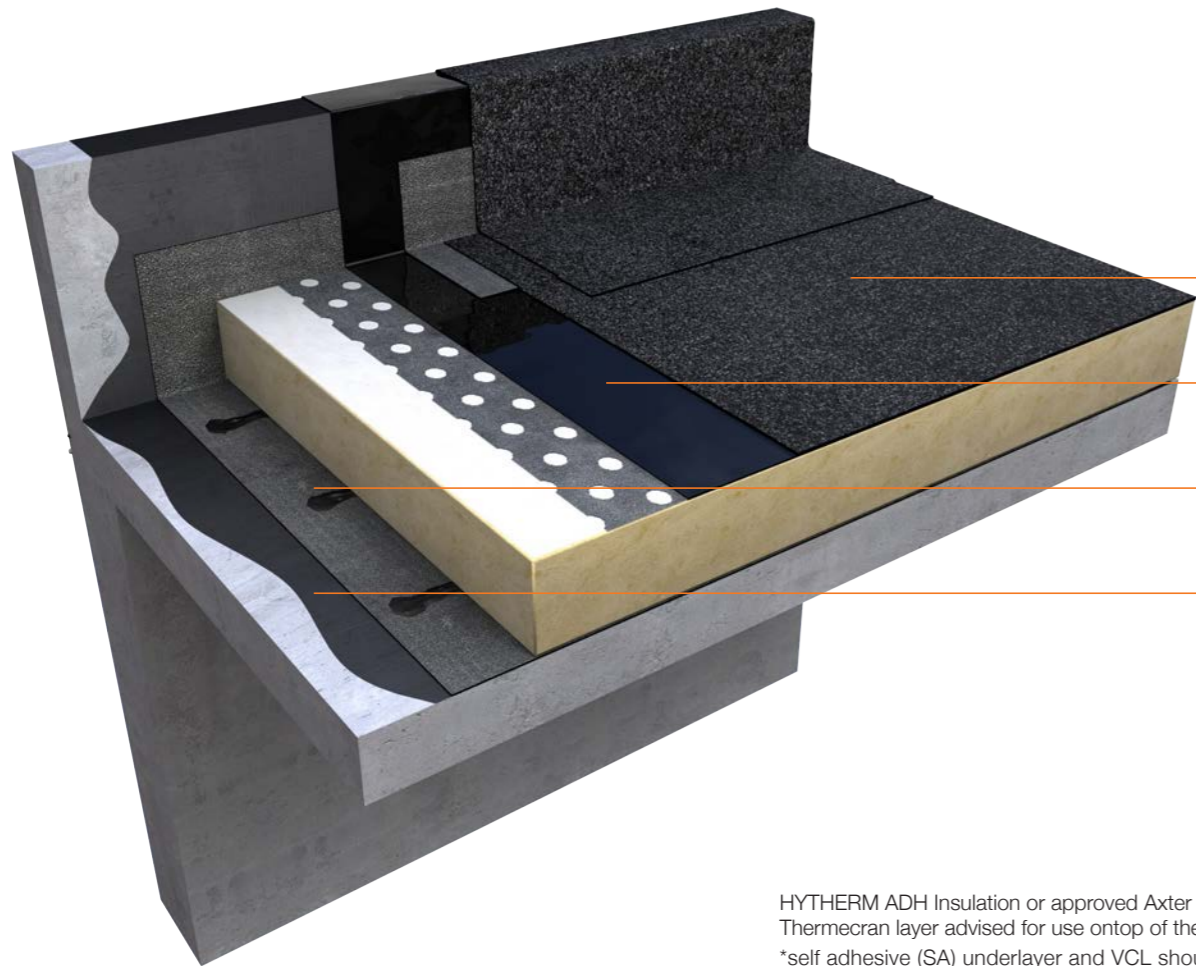

HYTHERM ADH Insulation or approved Axter equivalent to be used.  
Thermecran layer advised for use on top of the insulation  
\*self adhesive (SA) underlayer and VCL should be used on combustible substrates

# FORCE<sup>®</sup> LINE 3.5

High performance SBS **multi-layer** waterproofing system

FORCE LINE 3.5 RE

FORCE LINE 2VV\*

FORCE LINE 2S **or** FORCE LINE 2VV\*

FORCE PRIME

A cost effective multi-layer build up, FORCE<sup>®</sup> LINE 3.5 RE provides secure waterproofing, ideal for buildings where a 10 year material and labour warranty is sufficient.



Details can be completed with **STARCOAT R** flame free cold applied liquid waterproofing, contact Axter for more details.

**10** YEAR  
WARRANTY



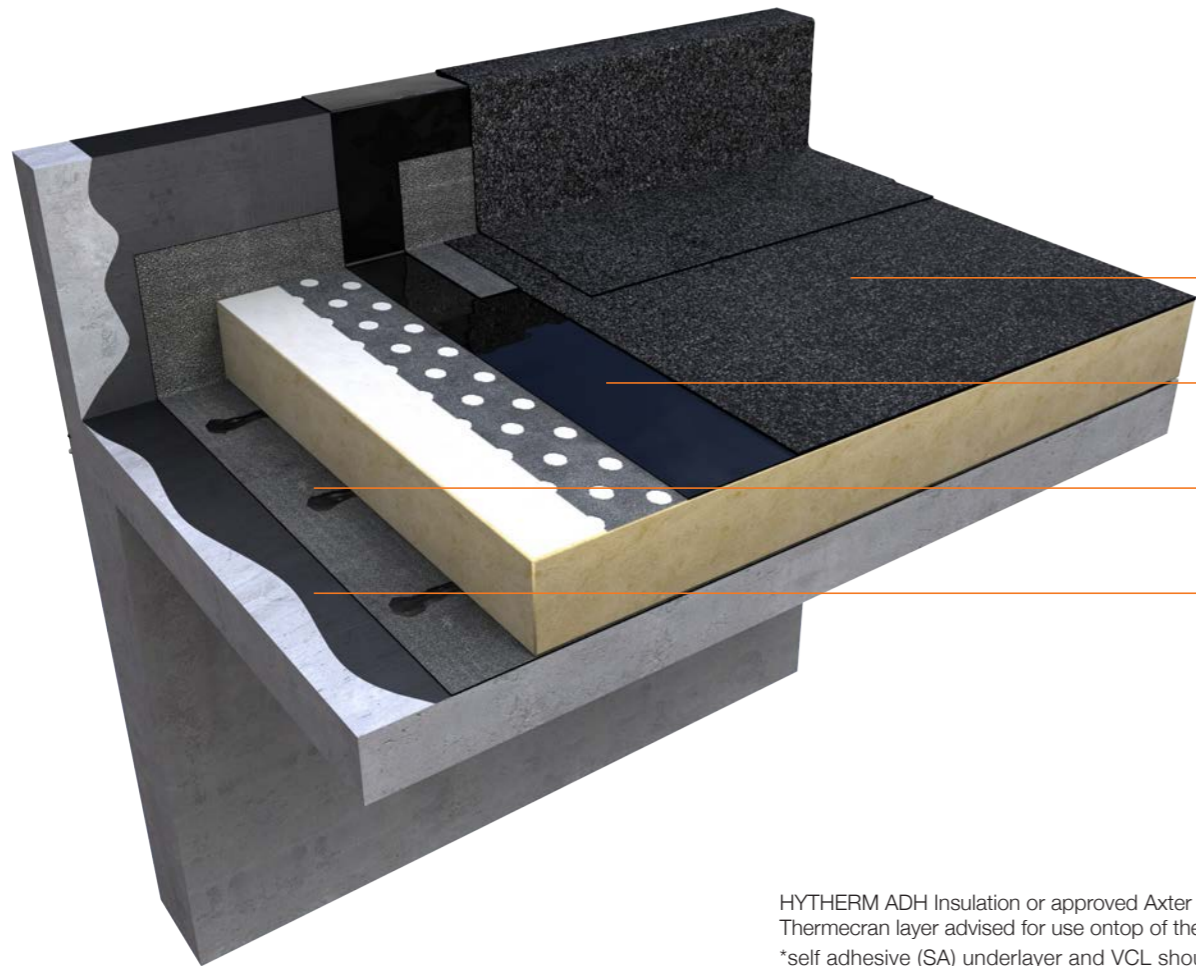

HYTHERM ADH Insulation or approved Axter equivalent to be used.  
Thermecran layer advised for use on top of the insulation  
\*self adhesive (SA) underlayer and VCL should be used on combustible substrates

# FORCE<sup>®</sup> LINE 4.0

High performance SBS **multi-layer** waterproofing system

FORCE LINE 4.0 RE

FORCE LINE 2VV\*

FORCE LINE 2S **or** FORCE LINE 2VV\*

FORCE PRIME

Increased material thickness and enhanced durability, the FORCE<sup>®</sup> LINE 4.0 RE cap sheet provides a hard wearing finish to a multi-layer build up and achieves a 15 year material and labour system warranty.



Details can be completed with **STARCOAT R** flame free cold applied liquid waterproofing, contact Axter for more details.

**15** YEAR  
WARRANTY



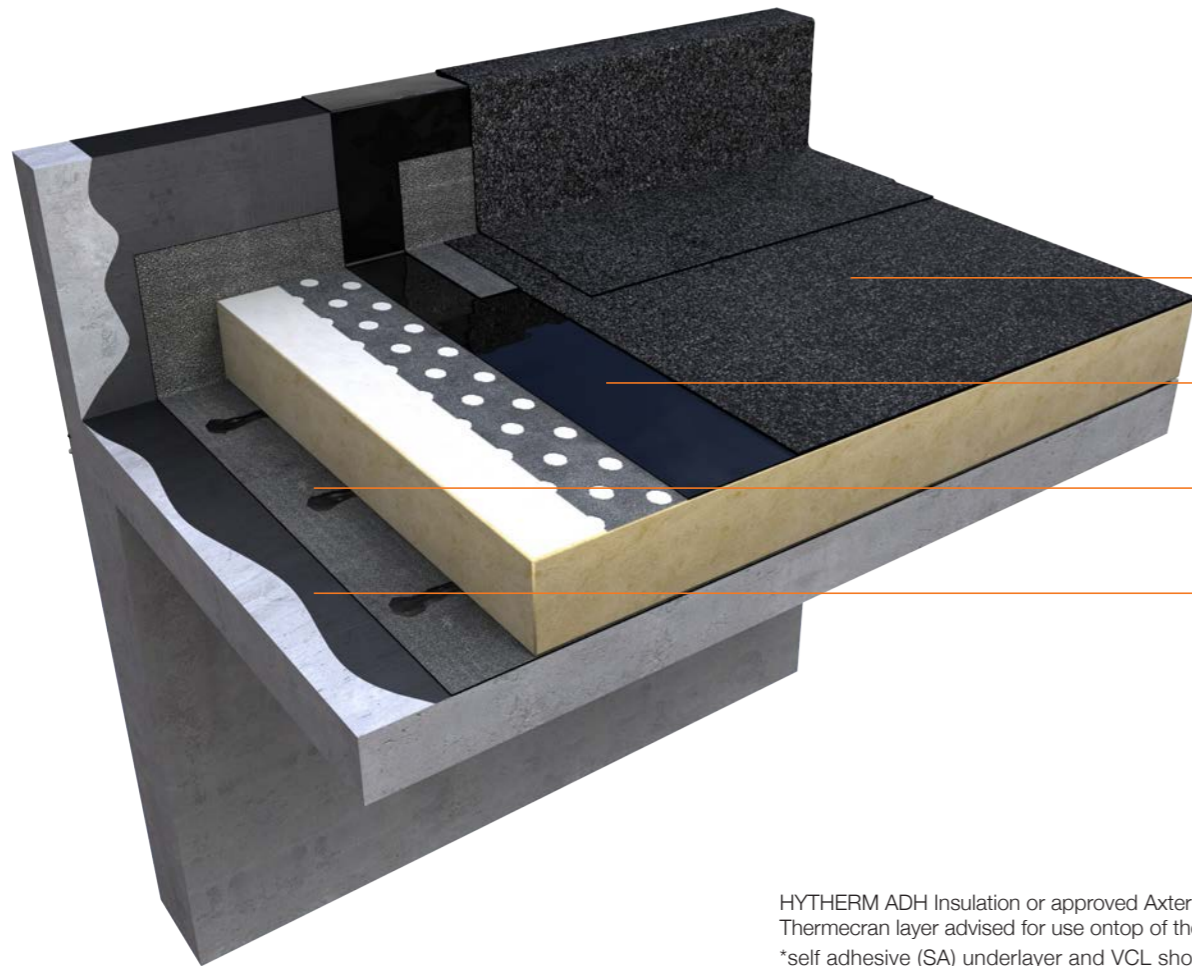

HYTHERM ADH Insulation or approved Axter equivalent to be used.  
Thermecran layer advised for use on top of the insulation  
\*self adhesive (SA) underlayer and VCL should be used on combustible substrates

# FORCE<sup>®</sup> LINE 4.5

High performance SBS **multi-layer** waterproofing system

FORCE LINE 4.5 RE

FORCE LINE 2VV\*

FORCE LINE 2S **or** FORCE LINE 2VV\*

FORCE PRIME

The thickest and most robust cap sheet within the multi-layer waterproofing range, FORCE<sup>®</sup> LINE 4.5 achieves a 20 year material and labour system warranty as standard.



Details can be completed with **STARCOAT R** flame free cold applied liquid waterproofing, contact Axter for more details.

**20** YEAR  
WARRANTY



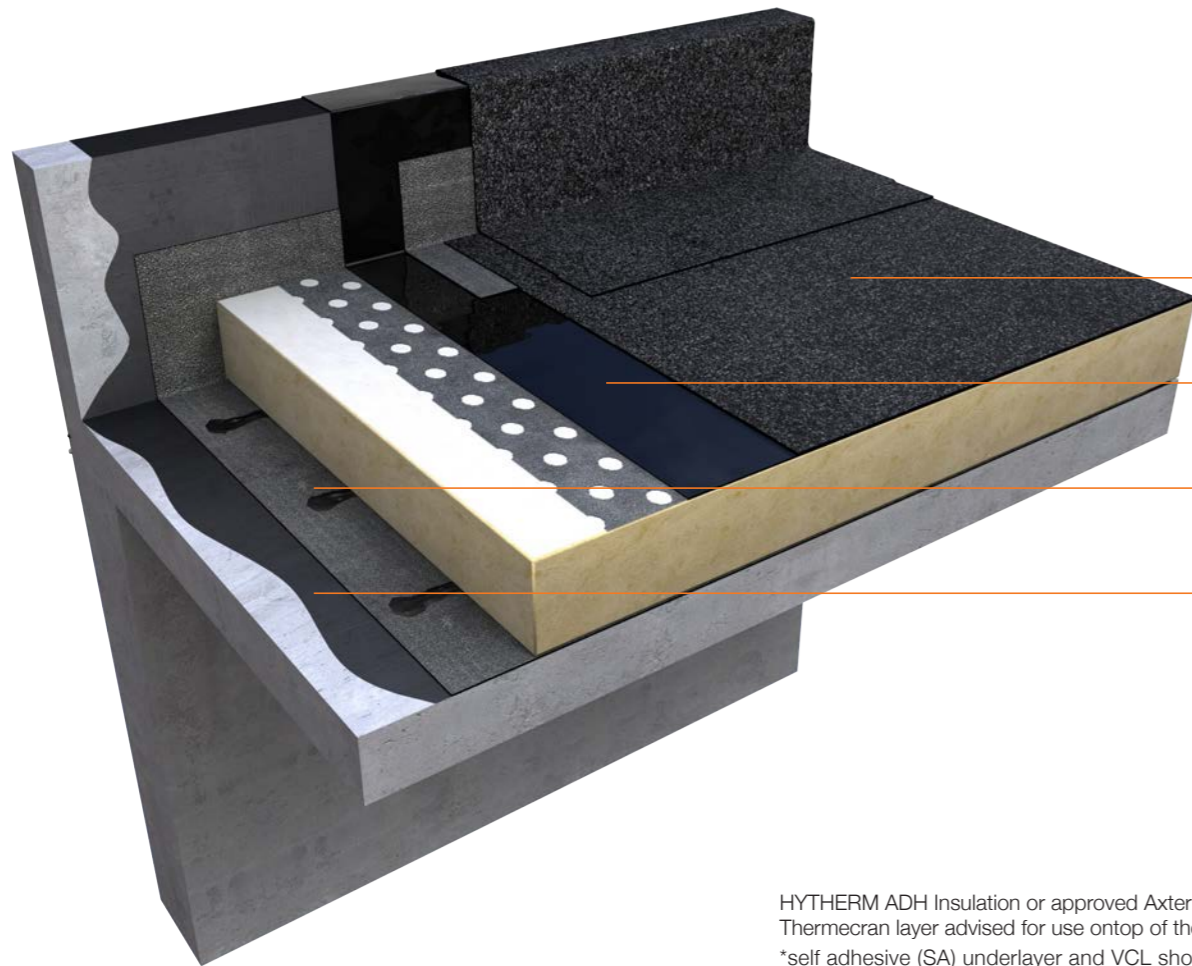

HYTHERM ADH Insulation or approved Axter equivalent to be used.  
 Thermecran layer advised for use on top of the insulation  
 \*self adhesive (SA) underlayer and VCL should be used on combustible substrates

# FORCE® LINE 4.5

High performance SBS **multi-layer** waterproofing system

FORCE LINE 4.5 RE

FORCE LINE 3VV\*

FORCE LINE 3VV\*

FORCE PRIME

When combined with FORCE® LINE 3VV underlayer and VCL as part of a multi-layer build up FORCE® LINE 4.5 achieves a market leading 25 year material and labour system warranty.



Details can be completed with **STARCOAT R** flame free cold applied liquid waterproofing, contact Axter for more details.

**25** YEAR  
 WARRANTY



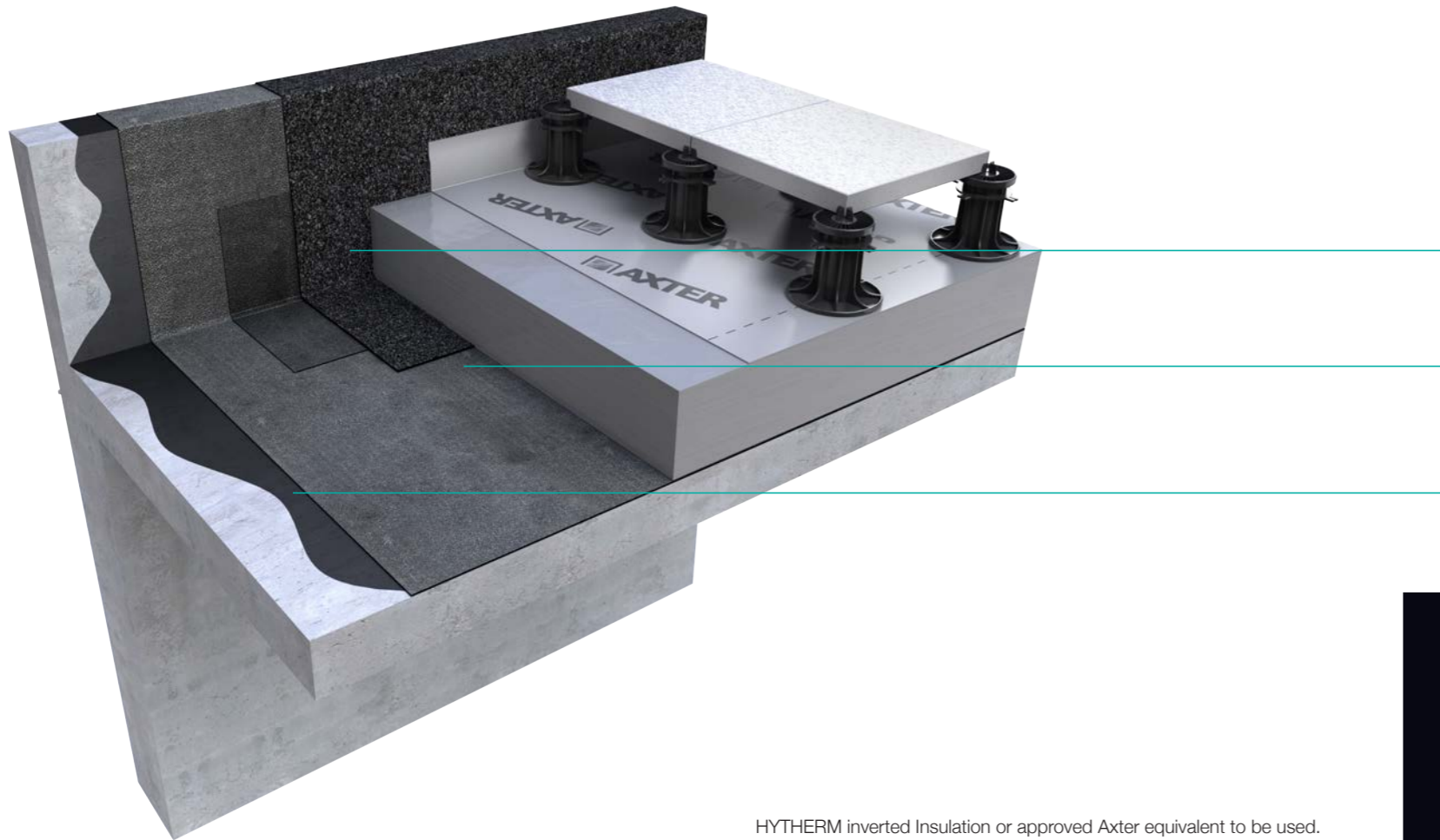

HYTHERM inverted Insulation or approved Axter equivalent to be used.

# FORCE® 3000 LINE RE

High performance SBS **inverted** roof waterproofing system

FORCE 3000 LINE RE

FORCE LINE 2VV

FORCE PRIME

A cost-effective inverted roof waterproofing build-up, FORCE® 3000 LINE RE provides robust waterproofing with a 15 year material and labour system warranty.



Details can be completed with **STARCOAT R** flame free cold applied liquid waterproofing, contact Axter for more details

**15** YEAR  
WARRANTY



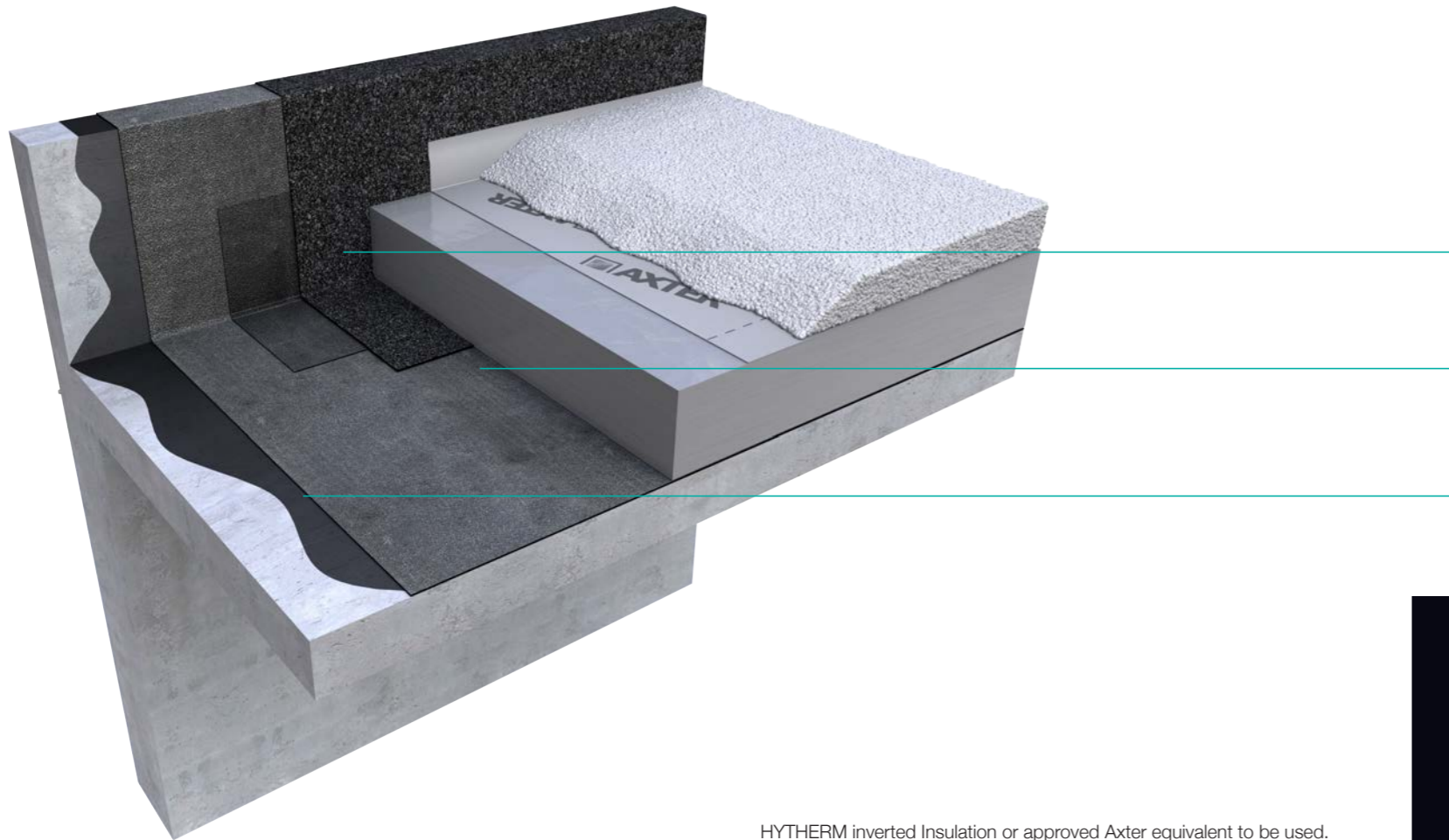

HYTHERM inverted Insulation or approved Axter equivalent to be used.

# FORCE® MB 40 PY

High performance SBS **inverted** roof waterproofing system

FORCE MB 40 PY

FORCE LINE 3VV

FORCE PRIME

An effective and hard wearing inverted roof waterproofing system. FORCE® MB 40 PY provides market leading durability and achieves a 20 year material and labour system warranty.



Details can be completed with **STARCOAT R** flame free cold applied liquid waterproofing, contact Axter for more details

**20** YEAR  
WARRANTY



# SINGLE LAYER

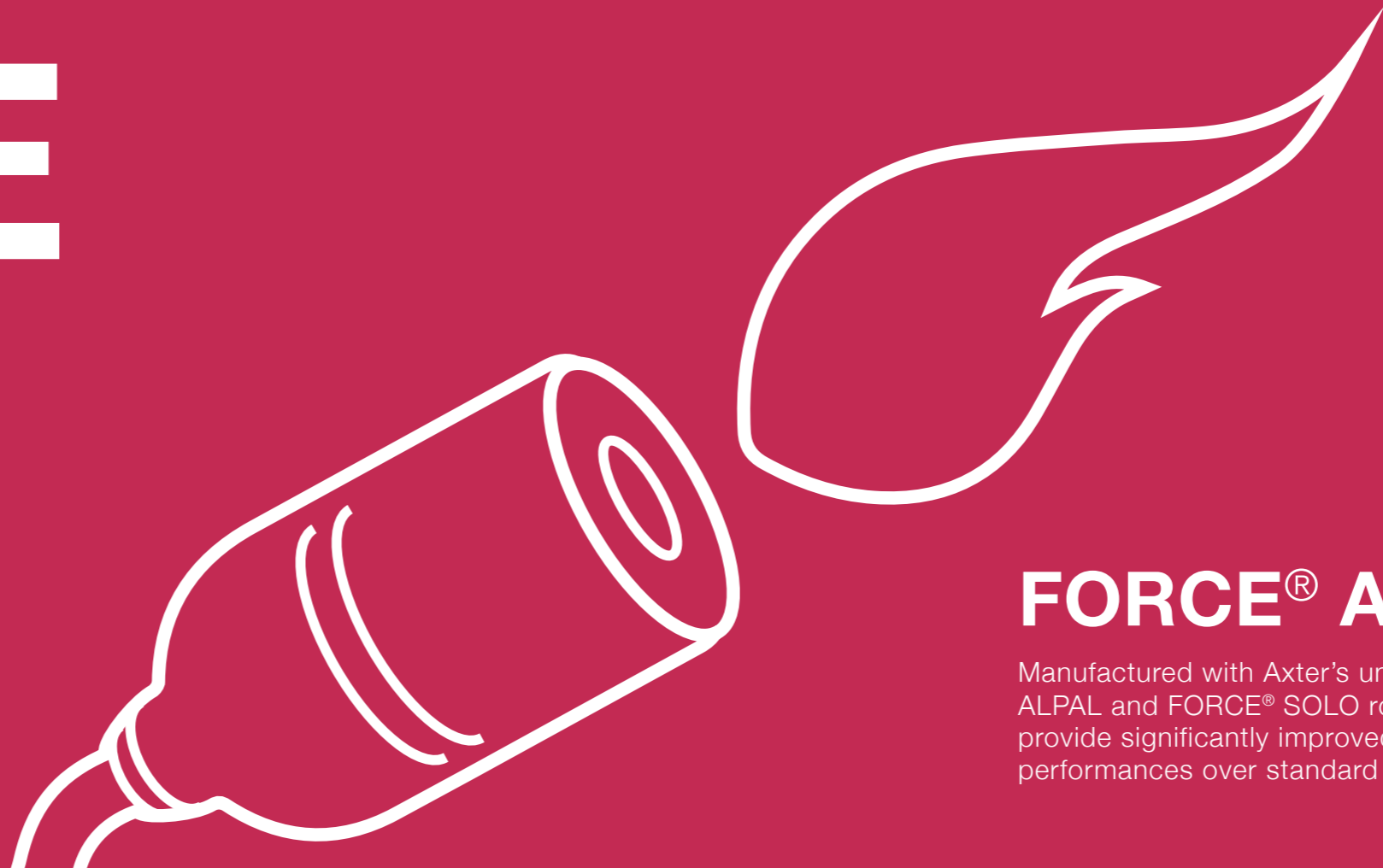

## **FORCE<sup>®</sup> ALPAL & SOLO**

Manufactured with Axter's unique ALPA<sup>®</sup> mix binder, FORCE<sup>®</sup> ALPAL and FORCE<sup>®</sup> SOLO roof waterproofing overlay membranes provide significantly improved ageing characteristics and durability performances over standard SBS bitumen membranes.

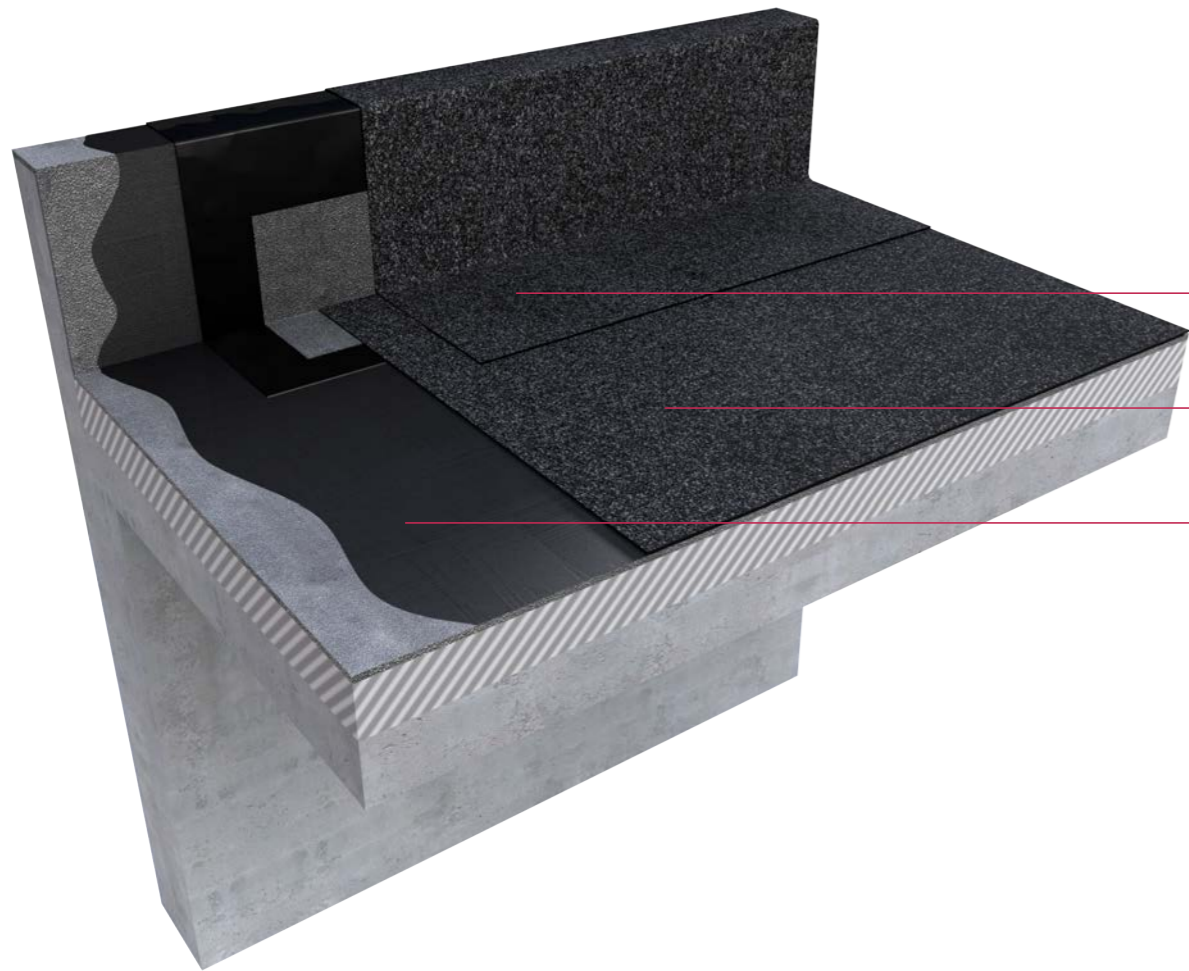

# FORCE® ALPAL 3000

High performance ALPA® SBS **single-layer** overlay system

FORCE LINE 2VV + FORCE ALPAL 3000

FORCE ALPAL 3000

FORCE PRIME

The ALPAL 3000 single layer capsheet contains our unique ALPA® binder formulation providing long lasting, easy to apply waterproofing. AA Fire rated achieving a 20 year material and labour warranty.



Details can be completed with **STARCOAT R** flame free cold applied liquid waterproofing, contact Axter for more details

**20** YEAR  
WARRANTY



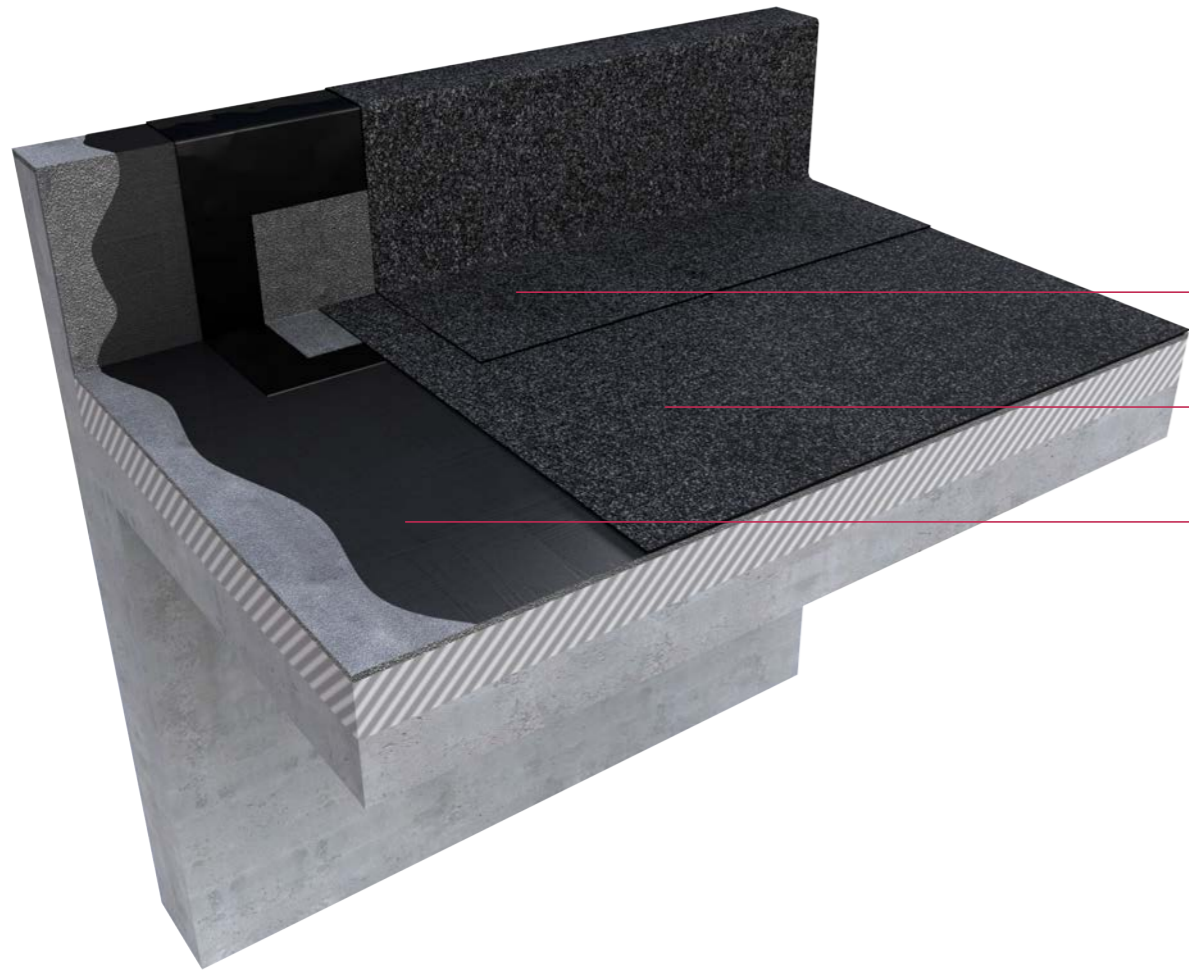

# FORCE® SOLO

High performance ALPA® SBS **single-layer** overlay system

FORCE LINE 3VV + FORCE SOLO

FORCE SOLO

FORCE PRIME

FORCE® SOLO is unique in its class. A highly robust single layer overlay membrane with ALPA® mix binder providing extended life expectancy, AA Fire rated and achieving a 25 year material and labour warranty as standard.



Details can be completed with **STARCOAT R** flame free cold applied liquid waterproofing, contact Axter for more details

**25** YEAR  
WARRANTY

# GREEN ROOF



## **FORCE<sup>®</sup> TRAFIC**

FORCE<sup>®</sup> TRAFIC waterproofing systems are perfectly adapted to the needs of green roofs with significant resistance to impact, roots, fertilisers and insecticides. FORCE<sup>®</sup> TRAFIC systems are BBA certified, conform to all standards and can be used under all forms of intensive and extensive green roof systems.

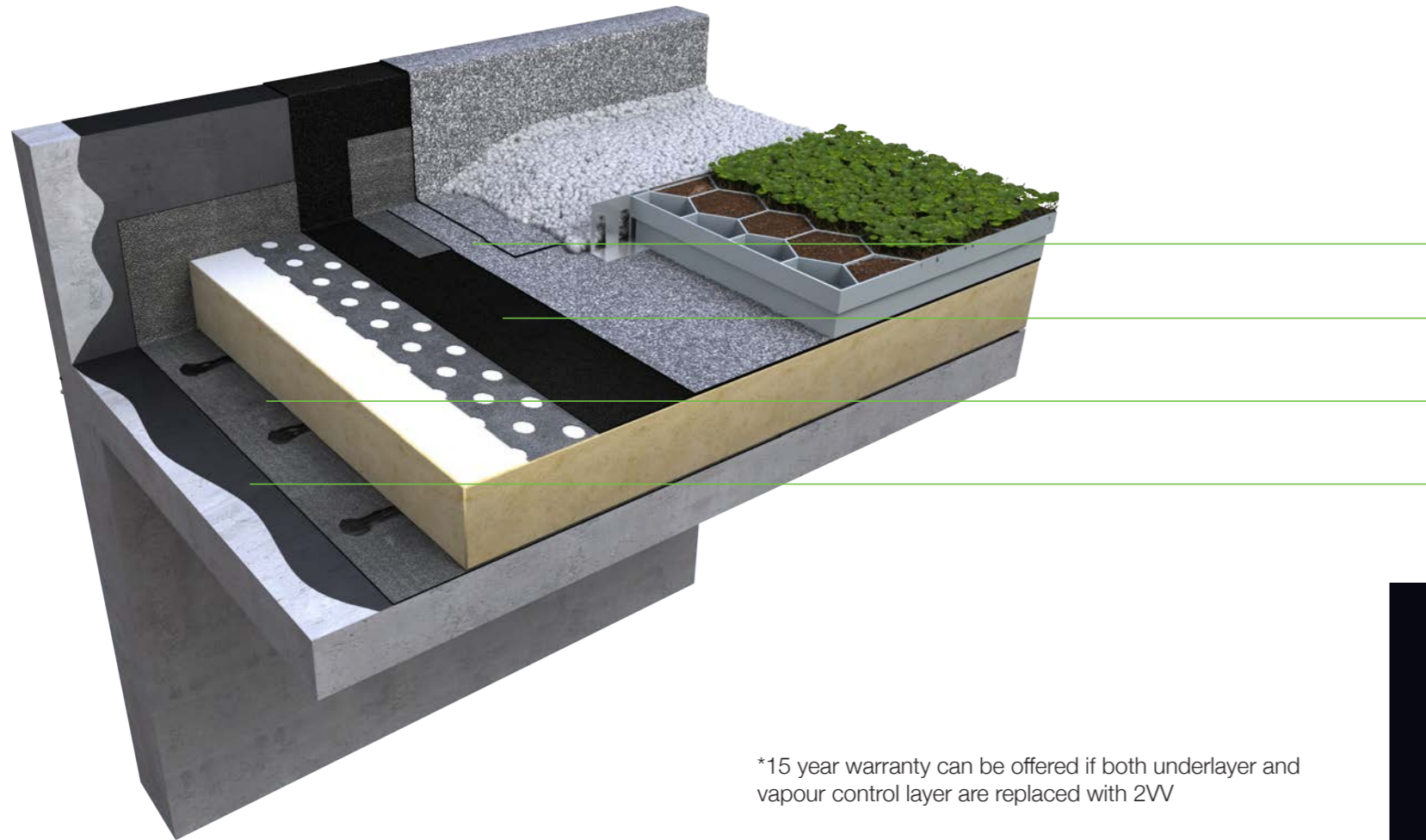

# FORCE® 3000 TRAFIC

High performance SBS **multi-layer** waterproofing system

FORCE 3000 TRAFIC

FORCE LINE 3VV\*

FORCE LINE 3VV\*

FORCE PRIME

\*15 year warranty can be offered if both underlayer and vapour control layer are replaced with 2VV

A BBA approved multi-layer green roof waterproofing system. FORCE 3000 TRAFIC is approved for use under all green roof types and achieved a 20 year material and labour system warranty as standard.



Details can be completed with **STARCOAT R** flame free cold applied liquid waterproofing, contact Axter for more details

20 YEAR  
WARRANTY



	10 YEAR	15 YEAR	20 YEAR	25 YEAR
<b>TORCH ON MULTI LAYER WATERPROOFING SYSTEMS</b>				
<b>Primer</b>	Force Prime	Force Prime	Force Prime	Force Prime
<b>VCL</b>	Force Line 2S or 2VV	Force Line 2S or 2VV	Force Line 2S or 2VV	Force Line 3VV
<b>Underlayer</b>	Force Line 2VV	Force Line 2VV	Force Line 2VV	Force Line 3VV
<b>Capsheet</b>	Force Line 3.5 RE	Force Line 4.0 RE	Force Line 4.5 RE	Force Line 4.5 RE
<b>Details</b>	Force Line 2VV + 3.5 RE	Force Line 2VV + 4 RE	Force Line 2VV + 4.5 RE	Force Line 3VV + 4.5 RE

<b>TORCH ON INVERTED WATERPROOFING SYSTEMS</b>				
<b>Primer</b>		Force Prime	Force Prime	
<b>Base Layer</b>	N/A	Force Line 2VV	Force Line 3VV	N/A
<b>Top Layer</b>		Force 3000 Line RE	Force MB 40 PY	

<b>SINGLE LAYER WATERPROOFING SYSTEMS</b>				
<b>Primer</b>			Force Prime	Force Prime
<b>Capsheet</b>	N/A		Force ALPAL 3000	Force Solo
<b>Details</b>			Force Line 2VV + Alpal 3000	Force Line 3VV + Solo

	10 YEAR	15 YEAR	20 YEAR	25 YEAR
<b>GREEN ROOF MULTI LAYER WATERPROOFING SYSTEM</b>				
<b>Primer</b>		Force Prime	Force Prime	
<b>VCL</b>		Force Line 2VV	Force Line 3VV	
<b>Underlayer</b>	N/A	Force Line 2VV	Force Line 3VV	N/A
<b>Capsheet</b>		Force 3000 Trafic	Force 3000 Trafic	
<b>Details</b>		Force Line 2VV + 3000 Trafic	Force Line 3VV + 3000 Trafic	

<b>SELF ADHESIVE</b>				
<b>Primer</b>	Force Prime	Force Prime	Force Prime	Force Prime
<b>VCL</b>	Force SA	Force SA	Force SA	Force SA
<b>Underlayer</b>	Force SA	Force SA	Force 2SA	Force SA
<b>Capsheet</b>	Force Line 3.5 RE	Force Line 4.0 RE	Force Line 4.5 RE	Force Solo
<b>Details</b>	Force SA + 3.5 RE	Force SA + 4 RE	Force SA + 4.5 RE	Force SA + Solo

# FORCE PRODUCT RANGE

PRODUCT NAME	surface finish	reinforcement (g/m <sup>2</sup> )	thickness (mm)	m <sup>2</sup> / roll	weight (kg)	rolls / pallet
<b>TORCH ON CAPSHEETS</b>						
FORCE LINE 3.5 <sup>1</sup>	Mineral Granules	120 polyester	3.5	8	37.6	25
FORCE LINE 4.0 RE <sup>2</sup>	Mineral Granules	150 polyester	4.0	8	43.2	25
FORCE LINE 4.5 RE <sup>3</sup>	Mineral Granules	180 polyester	4.5	8	44.2	23
FORCE 3000 TRAFIC	Mineral Granules	180 polyester	3.2	5	22.8	36
FORCE MB 40 PY	Sanded	180 polyester	4.0	10	51.3	20
FORCE 3000 LINE RE	Sanded	120 polyester	3.0	10	37.2	25
<b>Single Layer Overlay</b>						
FORCE ALPAL 3000 <sup>4</sup>	Mineral Granules	180 polyester	3.25	8	33.7	25
FORCE SOLO <sup>5</sup>	Mineral Granules	180 polyester	4.5	8	46.1	23
<b>VCL, Underlayer, Base Layer</b>						
FORCE LINE 2VV	Film	50 VV	2.0	16	49.9	23
FORCE LINE 3VV	Sanded	50 VV	3.0	10	42	25
FORCE LINE 2S	Sanded	50 VV	2.0	16	49.5	22
FORCE SA*	Film & Sand	50 VV	2.0	16	39.1	25
<b>Primer</b>						
FORCE PRIME	n/a	n/a	n/a	175 m <sup>2</sup> / drum	25 litres / drum	32

Colour options: <sup>1</sup>(Charcoal, Gris Ardennes, Natural Slate) <sup>2</sup>(Red/Brown, Charcoal, Gris Ardennes, Natural Slate) <sup>3</sup>(Red/Brown, Charcoal, Natural Slate) <sup>4</sup>(Charcoal, Natural Slate) <sup>5</sup>(Charcoal) \*self adhesive underlayer/VCL



FORCE®

Axter Ltd  
West Road  
Ransomes Europark  
Ipswich IP3 9SX

01473 724056  
[www.axter.co.uk](http://www.axter.co.uk)

