

- 1 Axter specified waterproofing and insulation system build-up
- 2 Hydrodrain/20 drainage and filtration membrane or Axter Drain and Axter Filter Layer (as shown)
- 3 >100mm graded variable depth recycled HYDROBROWN biodiverse brown roof substrate
- 4 Additional habitat creation in the form of log and rock piles
- 5 Indicitive structural build-up in accordance with the project architect's/engineer's design

NB: Optional HYDROSEED engineered Seed Mix broadcast onto substrate to further promote biodiversity

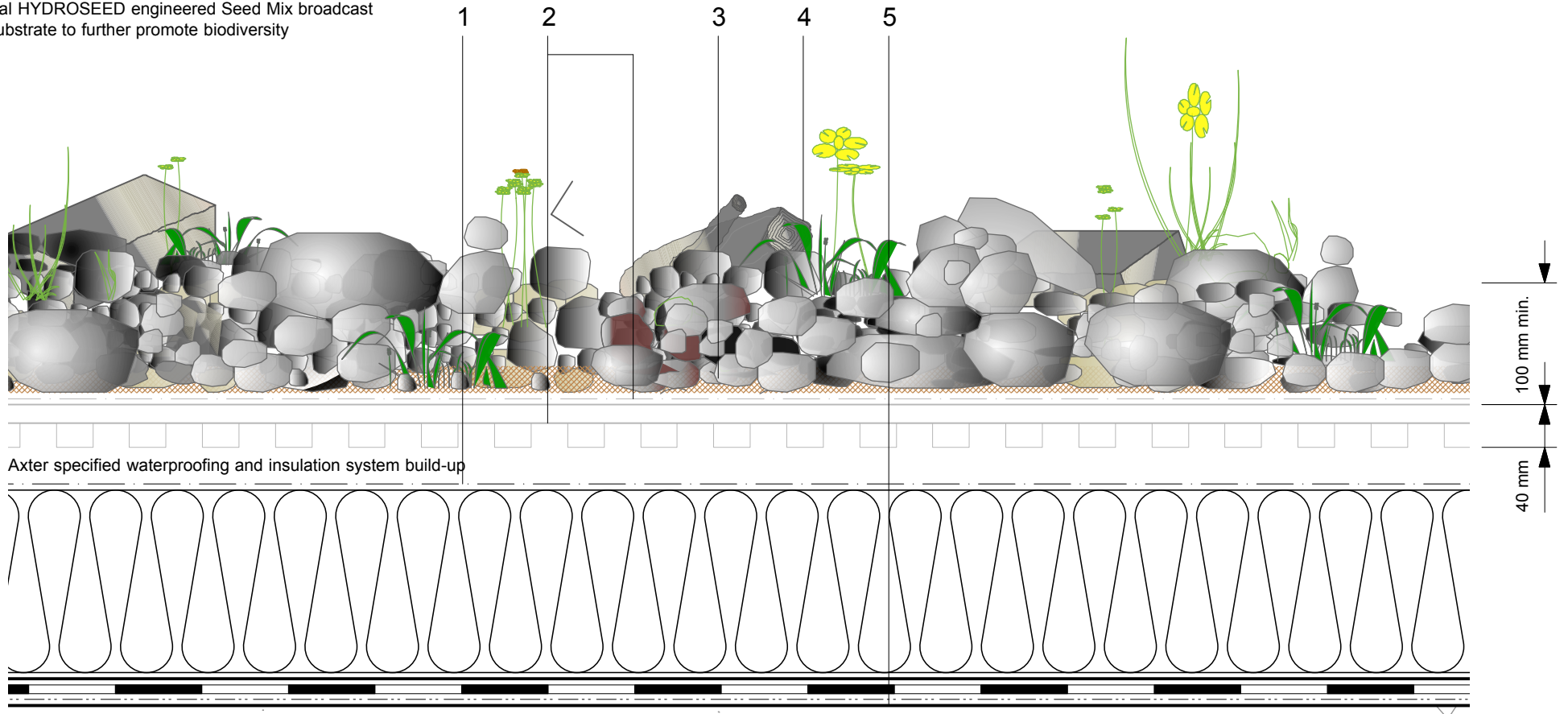

Do Not Scale. All dimensions to be checked on site by the Axtershield Installer

<p>Axter provides detail drawings as part of our technical design service. Such drawings should only be used as a guide during the design process and should not be utilised during construction. Axter accepts no liability for misuse of this service.</p>	<p>PROJECT</p> <p>AXTER - STANDARD DETAIL</p>	<p>DRAWING</p> <p>AXTER HYDROBROWN (BIODIVERSE) BROWN ROOF SYSTEM</p>		<p>AXTER LTD West Road, Ransomes Europark, Ipswich, Suffolk, IP3 9SX. Tel: (01473) 724056 Fax: (01473) 723263 info@axterltd.co.uk</p>	
	<p>DRAWING NUMBER</p> <p>GR.Hb.40</p>	<p>SCALE</p> <p>1:5 @ A4</p>	<p>DATE</p> <p>2014</p>		